

Series 7200DS : ENT Diaphragm Seal Extended neck type

ENT



Features

- All SS 316 construction
- Deal for slurry / high viscous fluids
- Flange & diaphragm are available in various type of SS & exotic materials

Applications

- Diaphragm seals are provided in the instruments like pressure gauges, switches, transmitters in order to isolate the sensing element from the main service due to its corrosive, viscous and sedimented nature and to avoid clogging and solidification
- These kind of seals are widely used in the viscous & corrosive services where flushing is required periodically & frequently

Specifications

Standard Version

(Compatible with Pressure gauges models : SSL (NS 100 mm & 150 mm)
Note: Pressure gauge will be provided with internal system of NS 63 mm

Diaphragm	:	AISI 316L SS
Body	:	AISI 316 SS
Flange	:	AISI 316 SS
Extension	:	50 mm (other extension on request)
Fill fluid	:	Silicon Oil - DC 200
Range	:	1 kg/cm ² to 250 kg/cm ² *
Process temperature	:	-40°C to 200°C or as per fill fluid
Instrument connection	:	½" BSP (F)
Process connection	:	Flange (Refer table)
Flange finish	:	Finish 125-250 AARH

* Range of selected instrument shall be suitable to flange pressure rating.

Flange Table With Ordering Codes

Code	Type	Code	Type
RF	Raised Face	FF	Flat Face

Flange Finish shall be 125 - 250 AARH as a standard. For other finish, please consult factory.
E.g. For flange size of 1 ½" Class 150 with raised face : B09 - RF

As per ANSI B 16.5								
NOMINAL SIZE	RATING / CLASS	CODE	NOMINAL SIZE	RATING / CLASS	CODE	NOMINAL SIZE	RATING / CLASS	CODE
½"	150	B09	1 ½"	150	B33	2 ½"	150	B45
	300	B10		300	B34		300	B46
	600	B11		600	B35		600	B47
	900	B12		900	B36		900	B48
	1500	B13		1500	B37		1500	B49
	2500	B14		2500	B38		2500	B50
1"	150	B21	2"	150	B39	3"	150	B51
	300	B22		300	B40		300	B52
	600	B23		600	B41		600	B53
	900	B24		900	B42		900	B54
	1500	B25		1500	B43		1500	B55
	2500	B26		2500	B44		2500	B56

Note: Design and Specifications subject to change without prior notice.

Dimensions Standard Version

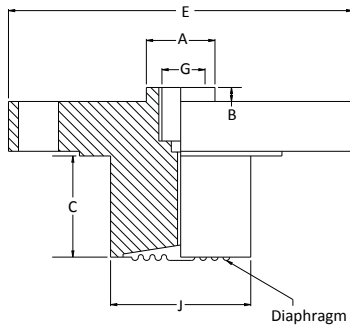

A	B	C	E	G	J
30	8	50*	**	½" BSP(F)	***

Notes : • Drawings are not to scale.
• All Dimensions are in mm.

* as per customer requirement
** As per standard BLRF flange table ANSI, DIN, BS, JIS Etc.
*** 40 / 53 / 63 / 70 mm (suitable to range & as per flange pressure rating.)

How To Order - Ordering Example: 7200DS: ENT.2BSF.SSL.SS.50mm.B09-RF.SS.UX.MTC

Basic Model		7200DS : ENT	
Code Instrument Connection			
2NPF	½" NPT (F)	2BSF	½" BSP (F)(Standard)
38BSF	3/8" BSP (F)		
Code Diaphragm		Code Diaphragm	Code Diaphragm
SSL	AISI 316L SS (Standard)	MON	Monel
HTLC	HASTELLOY 'C'		
It is recommended that the MOC of Diaphragm, Body and Flange should be equivalent.			
Code Body	Code Body	Code Body	Code Body
MON	Monel	HTLC	HASTELLOY 'C'
SSL	AISI 316L SS	SS	AISI 316 SS (Standard)
Code Body Length			
XX	Please Specify in mm Standard: 50 mm & Max. Up to 200 mm (e.g. 50 mm, 100 mm, 150 mm & 200 mm)		
Code Process Connection			
XX	Select Code From Flange Table		
Code Flange Material	Code Flange Material	Code Flange Material	Code Flange Material
MON	Monel	HTLC	HASTELLOY 'C'
SSL	AISI 316L SS	SS	AISI 316 SS (Standard)
Code Filling Fluids (* Consult factory for specifications, price and delivery.)			
US	Fluorolube 4.2 [-45 to 175 °C]	UY	Silicon DC 704 [10 to 337 °C]
UT	Fluorolube 6.3 [-40 to 235 °C]	UZ	Silicon DC 710 [7 to 371 °C]
UU	Fluorolube FS-5 [-28 to 148 °C]	VA	Syltherm 800 [-40 to 315 °C]
UV	Food Grade OIL [-20 to 140 °C]	VB	Syltherm XLT [-100 to 260 °C]
UX	Silicon DC 200 [-40 to 205 °C] (Standard)	VC	Halocarbon Oil*
Code Remote Mounting (With capillary of Max. Up to 6 Mtrs.)			
XX	Please Specify In Meters e.g. 1.5 = 1.5 METERS 2.0 = 2 METERS		
Code Capillary	Code Capillary		
SS3	AISI 304 SS	SS	AISI 316 SS
Code Capillary Covered With Armour (Applicable with Capillary if selected)			
SS3	AISI 304 SS	SS	AISI 316 SS
PVC	PVC (Ambient Temp. Max. 60°C)		
Code Options	Code Options	Code Options	
HLT	Helium Leak Test	TC	Dry Seal Only Without Instrument
MTC	Material Test Certificates*		

* Material test certificates will be provided for wetted parts only with chemical composition testing. For others, please consult factory.

Note: Design and Specifications subject to change without prior notice.